

# SPECIFICATIONS

MOULDING #	TG16TAB
CUSTOMER:	
COMMENTS:	20* HOOK

5/16 T1 CORR., 10MM AXIALS, 1.375 START DEPTH  
COPING: 7/8"- 1" WIDE, 1.25 START DEPTH, BEVEL FOR TENON, 20° HOOK, 2 HEAD ON 1 SHAFT  
SHAPER & US CONCEPTS: T1 5/16 CORR , 1.25 START DEPTH, 20° HOOK

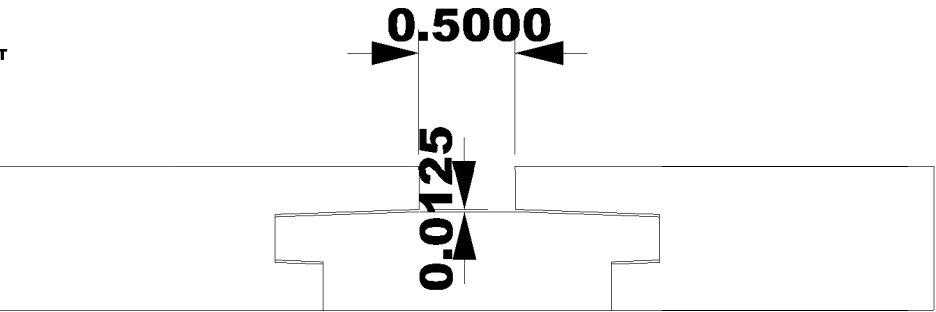

INSIDE OF MACHINE

